

NON-POWER FAILURE WEEKLY TIME SWITCH

QT 170

FEATURES

QT170 can be set to automatically switch on and switch off the power supply of various kinds of electric equipment. according to the user's preset time. It is widely used in programmed control of various electrical appliances as well as preheater, agricultural facilities and broadcasting equipment etc.

TECHNICAL DATA

SPECIFICATIONS

Rated Voltage	220V
Frequency	50 Hz
Power Consumption	<50VA
Timing Control Range	1 min ~ 168 hours
Temperature	-10°C+50 ° C
Dimension	36mm x 86mm x 65mm
Relative Humidity	<95°C
Weight	120g
Timing Error	<+/- 2s/day
Reserve Capacity	<150 hours



QT 170

\$60.00 EA

Connection Method

1. The Connection

The product has 1 normally open contact and 1 normally closed contact. The connection is showed as fig.1.

2. The connection for directly controlling single phase

The power of controlled electric should be supplied by single-phase and the power consumption is no more than the switch's rating capacity (resistance load 10A, sensibility load 6A). The connection is showed as fig.2.

3. The connection for three phase

The power of controlled electric should be supplied by three-phase. It need to connect to three-phase relay whose coil voltage is AC 380V/50Hz. The connection is showed as fig.3.

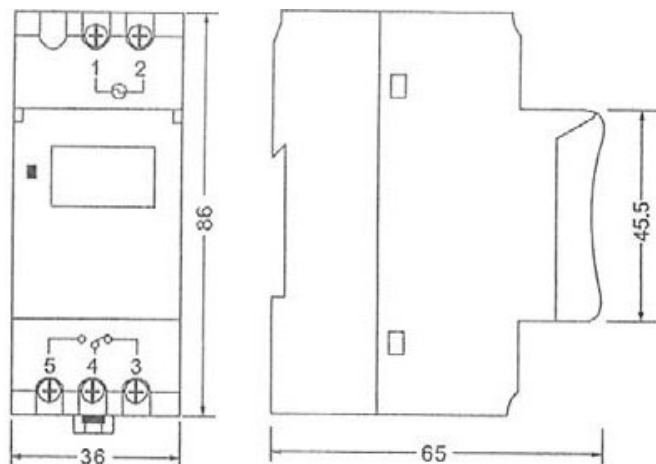

SAFETY INFORMATION

- Electrical Devices should only be connected and mounted by an electrical specialist.
- Manipulation and notifications on the switch will result in loss of warranty.
- National specifications and applicable safety regulations must be observed.